

Mounting description Head support rack

Netti Svipp 头靠支架安装说明

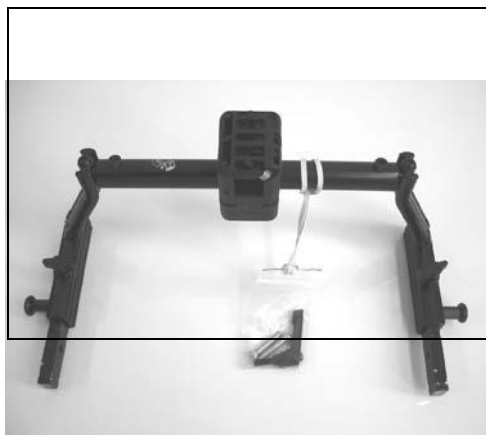

1



1. Untighten the adjustment wheel on both sides.

松开两侧翼型螺丝

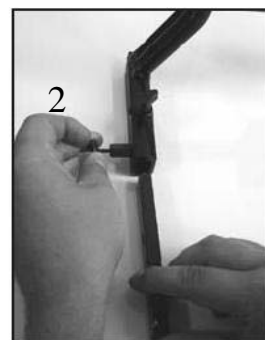

2. Open the spring lock and pull out the locking bar.

拉开弹簧锁销,拉出锁紧杆

3



3. Remove the plastic plug on top of the backrest tube, and unscrew the screw on the outside of the tube.

拆掉靠背支架管顶端的塑料塞并松开螺丝

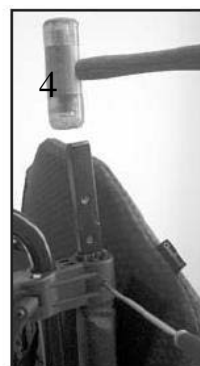

4. Place the locking bar into the backrest tube using a plastic hammer, and control it with a tool through the hole in the backrest tube to make sure that the holes are parallel.

用橡皮锤将锁紧杆敲入靠背支架管中,请确保两孔相对齐。

5



5. Fix the locking bolt with the enclosed screw, using a 4mm Allen key.

用 4MM 内六角扳手将所配螺丝锁紧

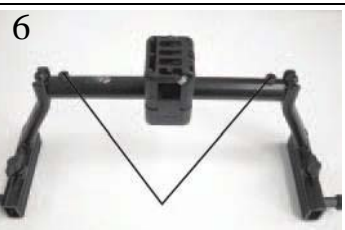

6. Untighten the screws on the telescope bar using a 5mm Allen key, and pull out to the required width.

用 5MM 内六角扳手松开伸缩杆上的螺丝,将其调节至合适的宽度。

7



7. Open the spring lock and lead the headrest rack onto the locking bar until you hear it clicks into position.

拉开弹簧锁销,将头靠支架导入锁紧杆中,到听到卡察声入孔为止



8. Tighten the adjustment wheel in the rear on both sides.

锁紧两边的翼形螺丝。

9



9. Tighten the screws on the telescope bar.

锁紧伸缩杆上的螺丝

10. Mount the enclosed adjustment lever to the plastic adapter.

将所配旋柄螺丝旋入塑料四方块孔中。

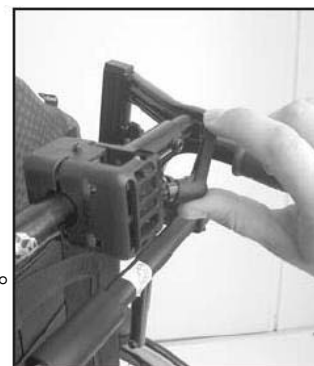

1
0

11. Mount the headrest, and make sure that it does not come in conflict with the tie bar on the top of the backrest of the wheelchair.

安装头靠时,确保其不影响靠背支架顶上的锁紧拉杆。

11



1
2

12. Tighten the screws on the plastic adapter diagonally with a 5mm Allen key.

使用 5MM 内六角扳手, 对角线扭紧塑料四方块上的螺丝

13. When the headrest is fitted, tighten the set screw properly with a 3mm Allen key, to avoid further movement.

装好头靠后,用 3MM 内六角扳手适当扭紧四方块上的定位螺丝以防止头靠晃动。

13



Never lift the chair in the headrest rack.

请勿在头靠支架处提起轮椅



Item number	Item
27214	Headrest rack Netti Svipp 35-45cm cpl
27215	Headrest rack Netti Svipp 50-55cm cpl